

● **Switches contact block**

SA ①	-	CA ②		
Classification	Ordering information		Description	
Model	①	②	Switches Accessories	
Contact /LED Block	SA			
		CA		A Contact (Normal open)
		CB		B Contact (Normal close)
		LD		LED Block (12-30VDC/AC)
		LA	LED Block (100-220VAC 50/60HZ)	

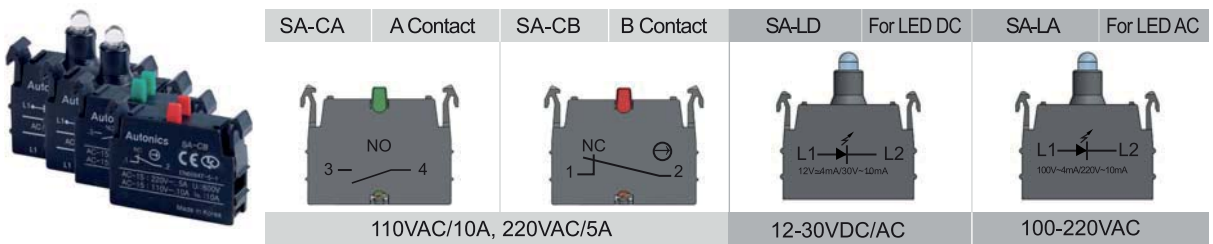

● **Switches boxes**

SA ①	-	SB ②	1 ③	
Classification	Ordering information			Description
Model	①	②	③	Switches accessories
Appearance	SA	SB		
Number of holes		TB		Triangle boxes
			1	1 hole (Length : L=86mm)
			2	2 hole (Length : L=136mm)
			3	3 hole (Length : L=186mm)
			4	4 hole (Length : L=236mm)
		5	5 hole (Length : L=286mm)	

※ The number of holes and box length can be customized

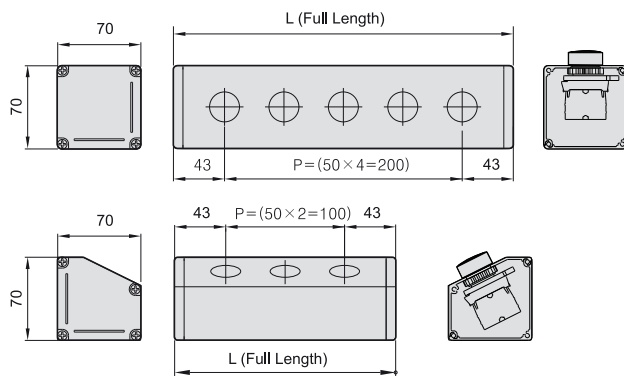

Dimensions (Unit : mm)
Mounting hole layout Ø22.5/25.5

● Emergency switches nameplates

SA	-	NS	
①		②	
Classification	Ordering information		Description
Model	① SA	②	Switches accessories
Appearance		NS	Nameplate small size
		NL	Nameplate large size



Panel mounting hole layout

It is recommended to leave the interval of 50 mm between each panel hole. In case of S2RE-E5R, leave the interval of 60mm or more.

(Unit : mm)

● Emergency switches protective shroud

SA	-	EG	1
①		②	③
Classification	Ordering information		Description
Model	① SA	②	③
Appearance		EG	
Dimension		1	Ø22, SMALL
		2	Ø22, LARGE
		3	Ø25, LARGE

● Dimension of small type

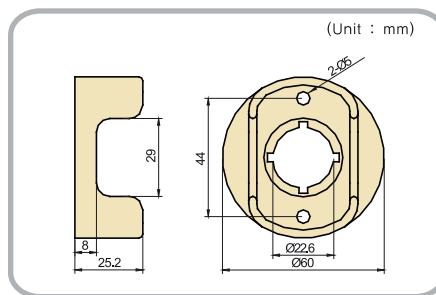

● Dimension of large type

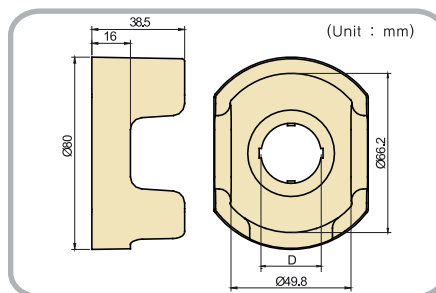

D part Dimension	
SA-EG2	Ø22.5
SA-EG3	Ø25.5

Push button switches

Push button switches (Illuminated)

Selector switches

Double push button switches

Start push button switches

Emergency switches

Emergency switches (Illuminated)

Pilot lamps

Accessory

Magnetic buzzers

Piezo buzzers

Sockets

Digital switches

● **Water proof cap**

SA	-	WP	
①		②	
Classification	Ordering information		Description
Model	①	- ②	Switch accessories
Appearance	SA	WP	For push button
		WL	For Illuminated push button

(Unit : mm)

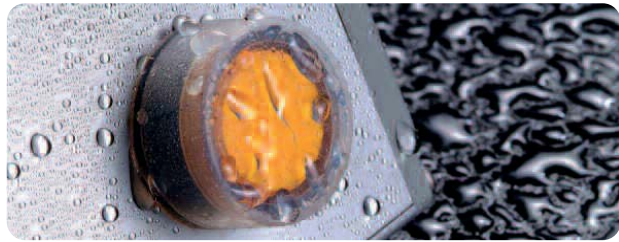
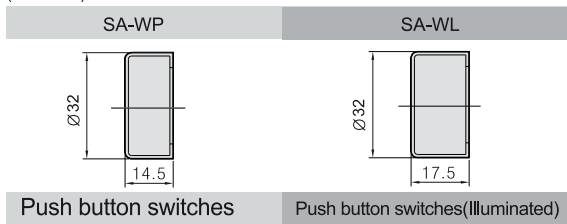

* For Non-flush Ø22/25 Non-Flush switches

● **Locking handle for switches**

SA	-	LH	
①		②	
Classification	Ordering information		Description
Model	①	- ②	Switch accessories
Appearance	SA	LH	Locking ring wrench (Locking handle)

(Unit : mm)

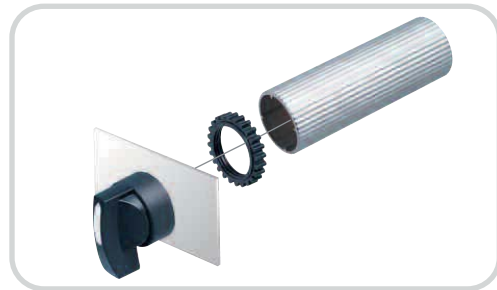
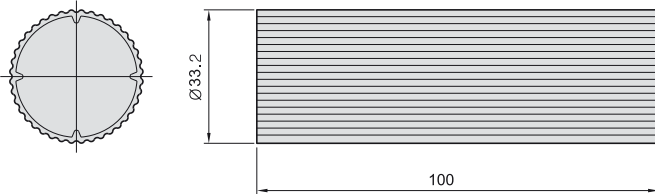

When mounting Ø25 panel hole,



contact A part



When mounting

Ø22 panel hole,
contact B part



● **Guideline for mounting switch Nut**

Available for Ø22/25 Flush Push buttons. When Mounting Ø25 panel hole, contact A part with switch nut . When Mounting Ø22 panel hole, contact B part with switch nut