







<b>S</b>	<b>2</b>	<b>ER</b>	<b>-</b>	<b>E1</b>	<b>R</b>	<b>B</b>	<b>D</b>
①	②	③		④	⑤	⑥	⑦

Classification	Ordering information							Description		
	①	②	③	-	④	⑤	⑥		⑦	
Model	S								Control switches	
Dimension	2								Ø22/25	
Appearance			ER						Emergency switches	
Operation					E1				Head Ø30(L) Push-Lock, Turn-Reset	
					E2				Head Ø30(S) Push-Lock, Turn-Reset	
					E3				Head Ø40 Push-Lock, Turn-Reset	
					E4				Head Ø40 Push-Lock, Turn-Reset(Illuminated)	
					E5				Head Ø60 Push-Lock, Turn-Reset	
Color						R			RED	
Contact / LED Block							A		A (Normal Open) 110VAC/10A, 220VAC/5A	
							B		B (Normal Close) 110VAC/10A, 220VAC/5A	
								D	LED 12-30VDC/AC	
								L	LED 100-220VAC	

## ● Ø22/25 Head D30L Emergency switches (Non-Flush)



Model	Contacts	
	A contact	B contact
S2ER - E1RA	1EA	
" - " 2A	2EA	
" - " 3A	3EA	
" - " B		1EA
" - " 2B		2EA
" - " 3B		3EA
" - " AB	1EA	1EA
" - " 2AB	2EA	1EA
" - " A2B	1EA	2EA

- Space-saving design
- Mounting hole layout : Ø22.5 / 25.5mm
- PUSH LOCK & TURN RESET

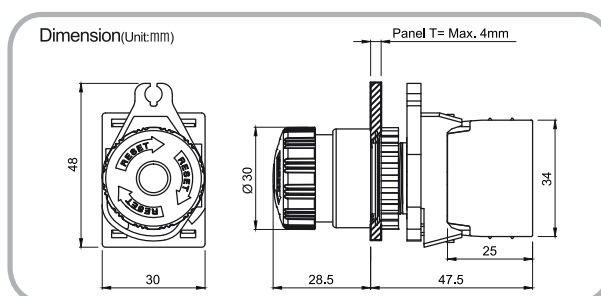



## ● Ø22/25 Head D30S Emergency switches (Non-Flush)



## ● Ø22/25 Head D40 Emergency switches (Non-Flush)



Model	Contacts	
	A contact	B contact
S2ER - E2RA	1EA	
" - " 2A	2EA	
" - " 3A	3EA	
" - " B		1EA
" - " 2B		2EA
" - " 3B		3EA
" - " AB	1EA	1EA
" - " 2AB	2EA	1EA
" - " A2B	1EA	2EA

- Space-saving design
- Mounting hole layout : Ø22.5 / 25.5mm
- PUSH LOCK & TURN RESET

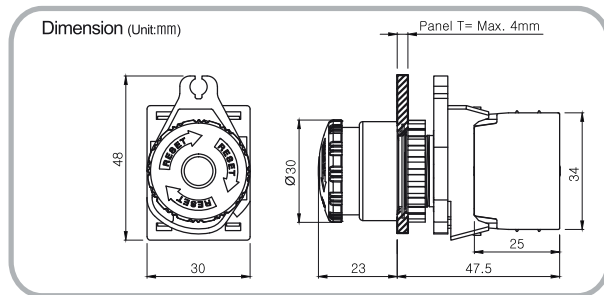

Model	Contacts	
	A contact	B contact
S2ER - E3RA	1EA	
" - " 2A	2EA	
" - " 3A	3EA	
" - " B		1EA
" - " 2B		2EA
" - " 3B		3EA
" - " AB	1EA	1EA
" - " 2AB	2EA	1EA
" - " A2B	1EA	2EA

- Simple and elegant design
- Mounting hole layout : Ø22.5 / 25.5mm
- PUSH LOCK & TURN RESET

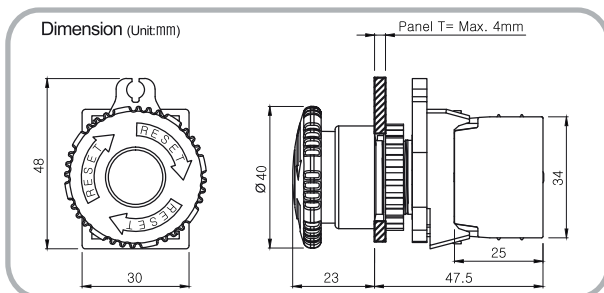

Push button switches

Push button switches (Illuminated)

Selector switches

Double push button switches

Start push button switches

Emergency switches

Emergency switches (Illuminated)

Pilot lamps

Accessory

Magnetic buzzers

Piezo buzzers

Sockets

Digital switches



● **Ø22/25 Head D40 Emergency switches (Illuminated Non-Flush)**



Model	Contacts		LED	
	A contact	B contact	DC type	AC type
S2ER - E4RAD	1EA		1EA	
" - " 2AD	2EA		1EA	
" - " BD		1EA	1EA	
" - " 2BD		2EA	1EA	
" - " ABD	1EA	1EA	1EA	
" - " AL	1EA			1EA
" - " 2AL	2EA			1EA
" - " BL		1EA		1EA
" - " 2BL		2EA		1EA
" - " ABL	1EA	1EA		1EA

- Improved visibility with high luminance LED
- Mounting hole layout : Ø22.5 / 25.5mm
- PUSH LOCK & TURN RESET

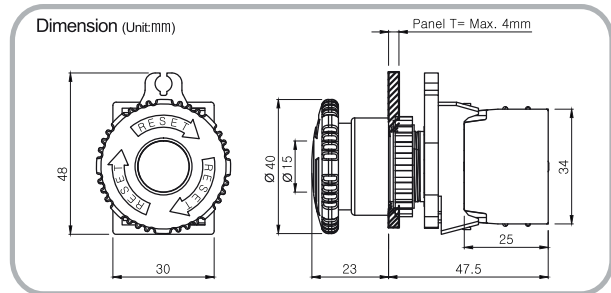

● **Ø22/25 Head D60 Emergency Switches (Non-Flush)**



Model	Contacts	
	A contact	B contact
S2ER - E5RA	1EA	
" - " 2A	2EA	
" - " 3A	3EA	
" - " B		1EA
" - " 2B		2EA
" - " 3B		3EA
" - " AB	1EA	1EA
" - " 2AB	2EA	1EA
" - " A2B	1EA	2EA

- Increasing user convenience with large size head (Ø60)
- Mounting hole layout : Ø22.5 / 25.5mm
- PUSH LOCK & TURN RESET

